



Flat A

Owlsmoor Road | Sandhurst | Berkshire | GU47 0SS

£975 PCM

*Waterford's* W  
Residential Sales & Lettings

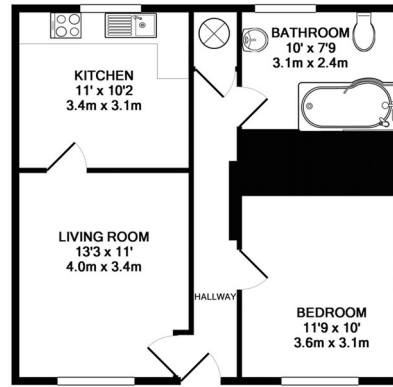

TOTAL APPROX. FLOOR AREA 521 SQ.FT. (48.4 SQ.M.)  
 Whilst every attempt has been made to ensure the accuracy of the floor plan contained here, measurements of doors, windows, rooms and any other items are approximate and no responsibility is taken for any error, omission, or mis-statement. This plan is for illustrative purposes only and should be used as such by any prospective purchaser. The services, systems and appliances shown have not been tested and no guarantee as to their operability or efficiency can be given.  
 Made with Metropix ©2017

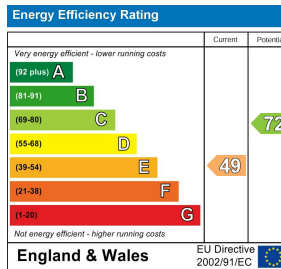

## Description

One-Bedroom Apartment to Let – Owlsmoor Road, Sandhurst

Charming one-bedroom first-floor apartment available now on Owlsmoor Road in Sandhurst. This bright and well-presented property features a spacious double bedroom, modern bathroom, open-plan living area with fitted kitchen, and plenty of natural light throughout. Conveniently located close to local amenities, transport links, and shops, it's ideal for professionals or couples seeking comfortable, easy-to-maintain accommodation. Available immediately.

## Key features

- One Bedroom Apartment
- Kitchen / Breakfast Room
- Allocated Parking
- Council Tax Band B
- Long Term Let
- Modern Finnish Through Out
- Good Size Living Room
- Unfurnished and Available Now
- EPC D



35 Plough Road  
 Hampshire  
 GU46 7UW  
 01276 903006

surreylettings@waterfords.co.uk  
<https://www.waterfords.co.uk/>